

HERMAN FAMILY OF SCHOOLS



Tuesday June 12, 2012

WHAT IS A PARC?

P = PROGRAM

A = ACCOMMODATION

R = REVIEW

C = COMMITTEE

TRUSTEE'S MOTION

That the Superintendent responsible for Accommodations conducts a PARC study of The Herman Family of Schools to:

- Alleviate over capacity enrolment at McCallum
- Relieve the number of empty student spaces and improve the utilization rates within the family of schools.

WHY A PARC?

Greater Essex County District School Board Renewal Event Costs vs. Base Funding

Printed On: 2011/08/17

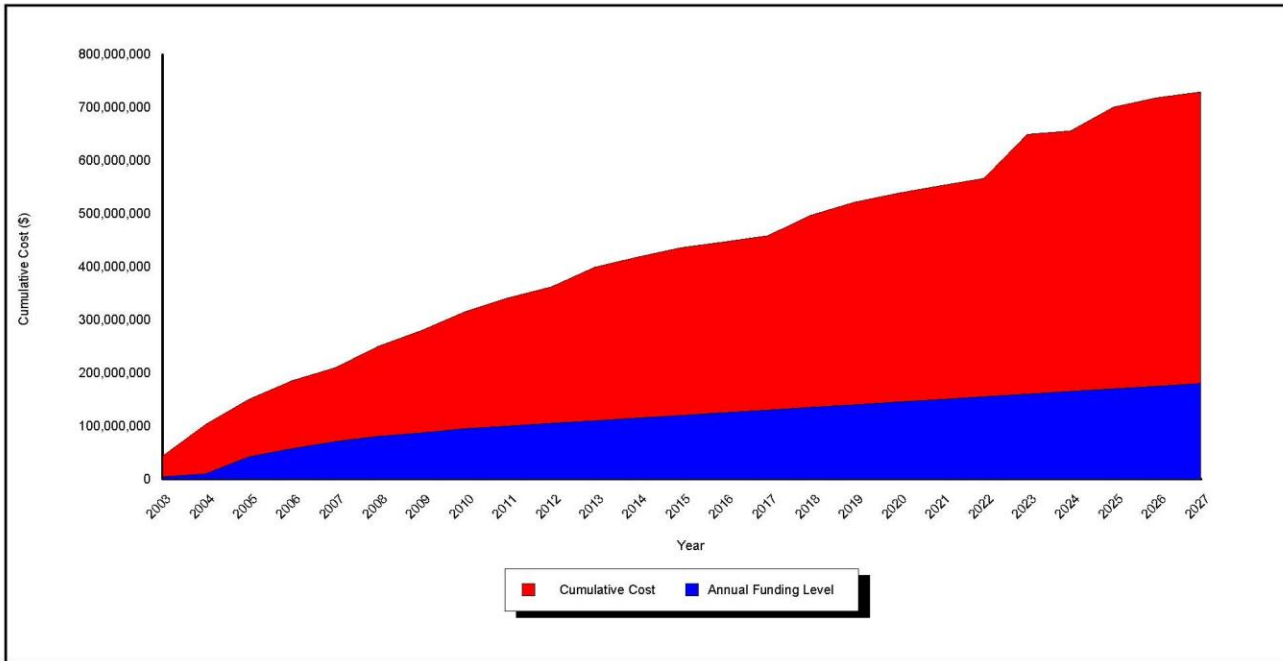

This report was generated without using Virtual Events.

Cumulative Event Costs / Cumulative Annual Funding / Permanent Learning Facilities

High and Urgent Renewal Needs by Category

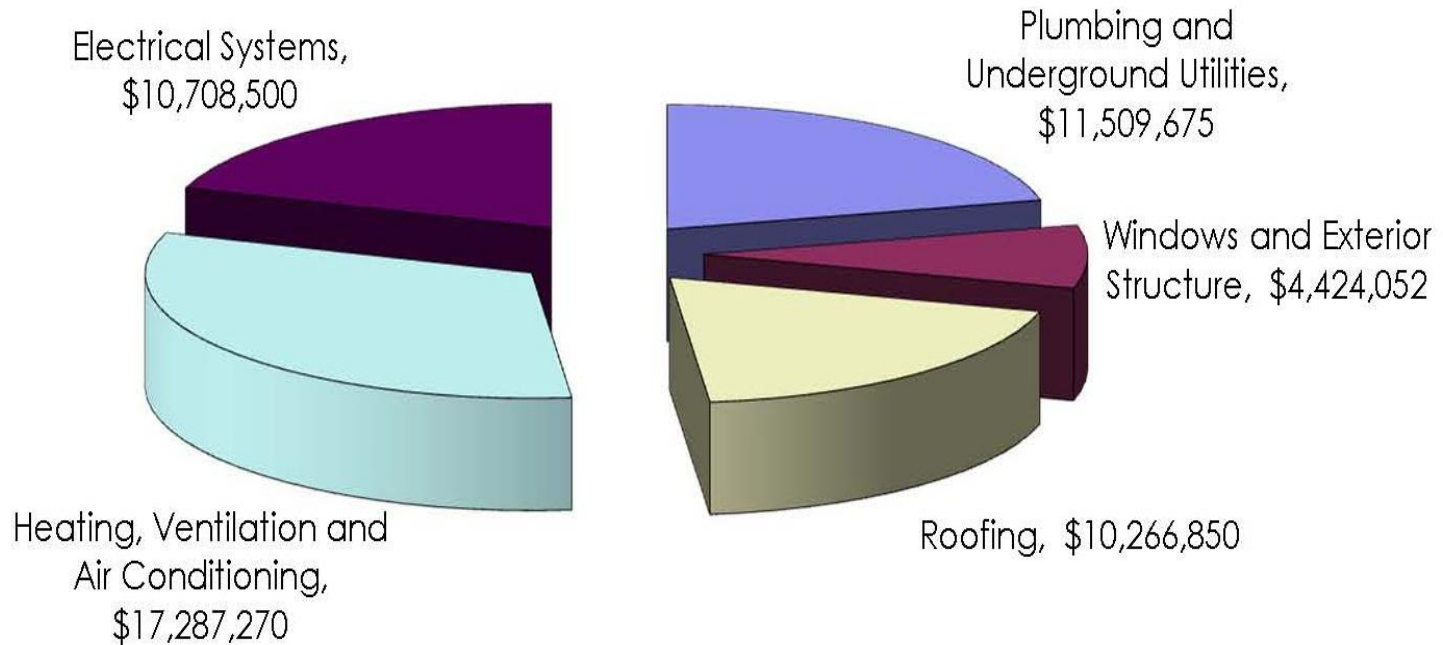

Average Daily Enrolment and Empty Spaces

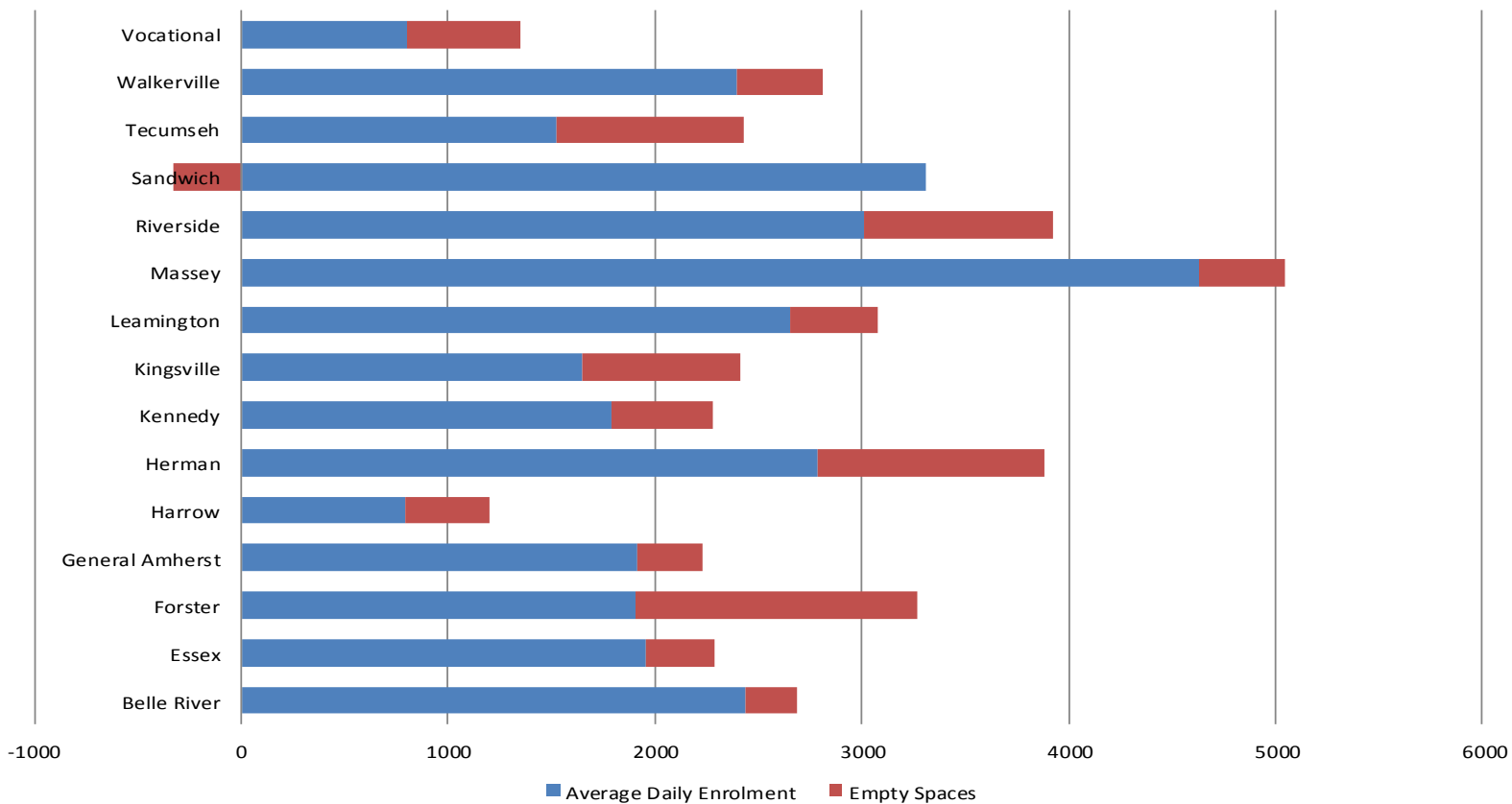

Herman Family of Schools

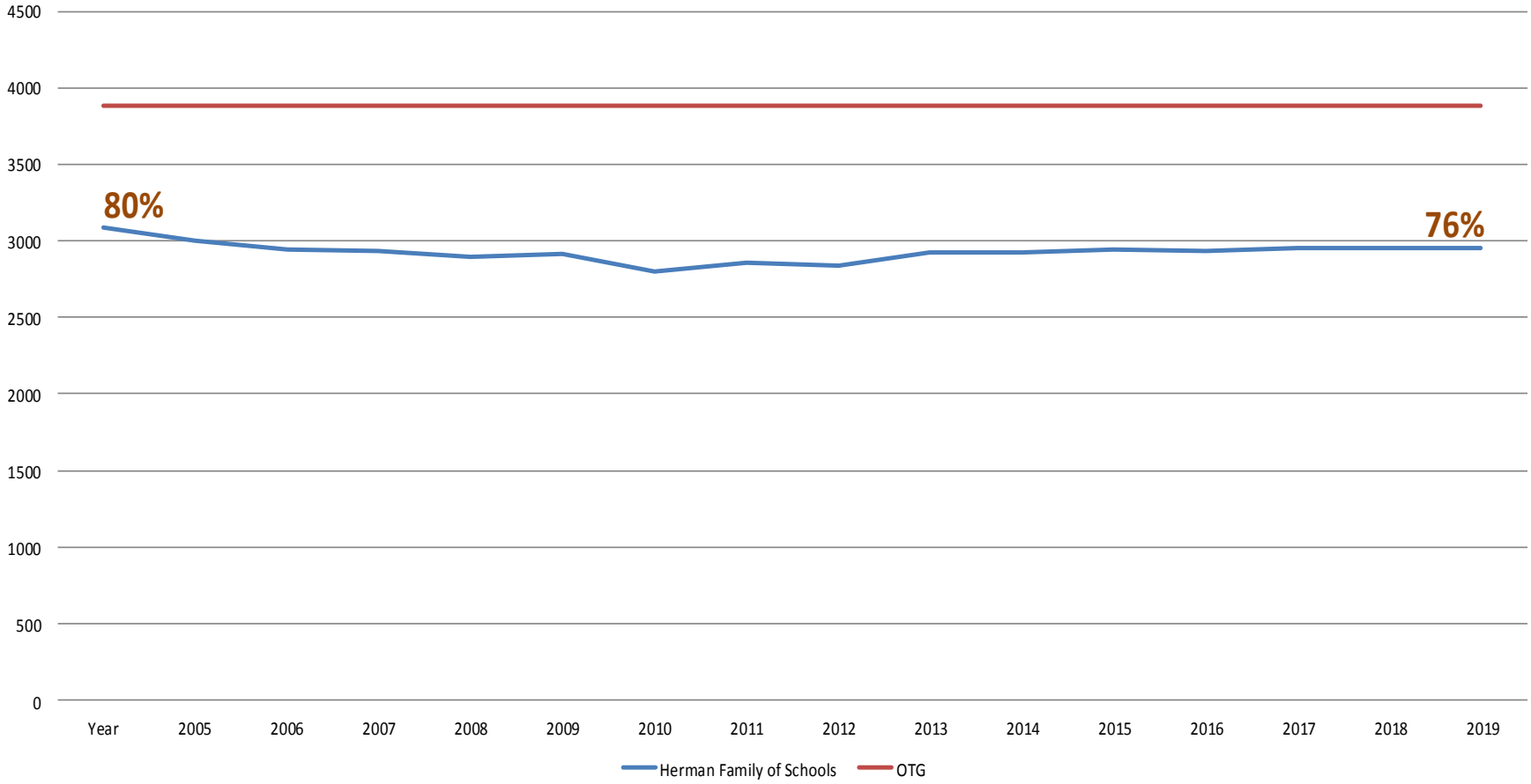

Herman Family of Schools (No FI)

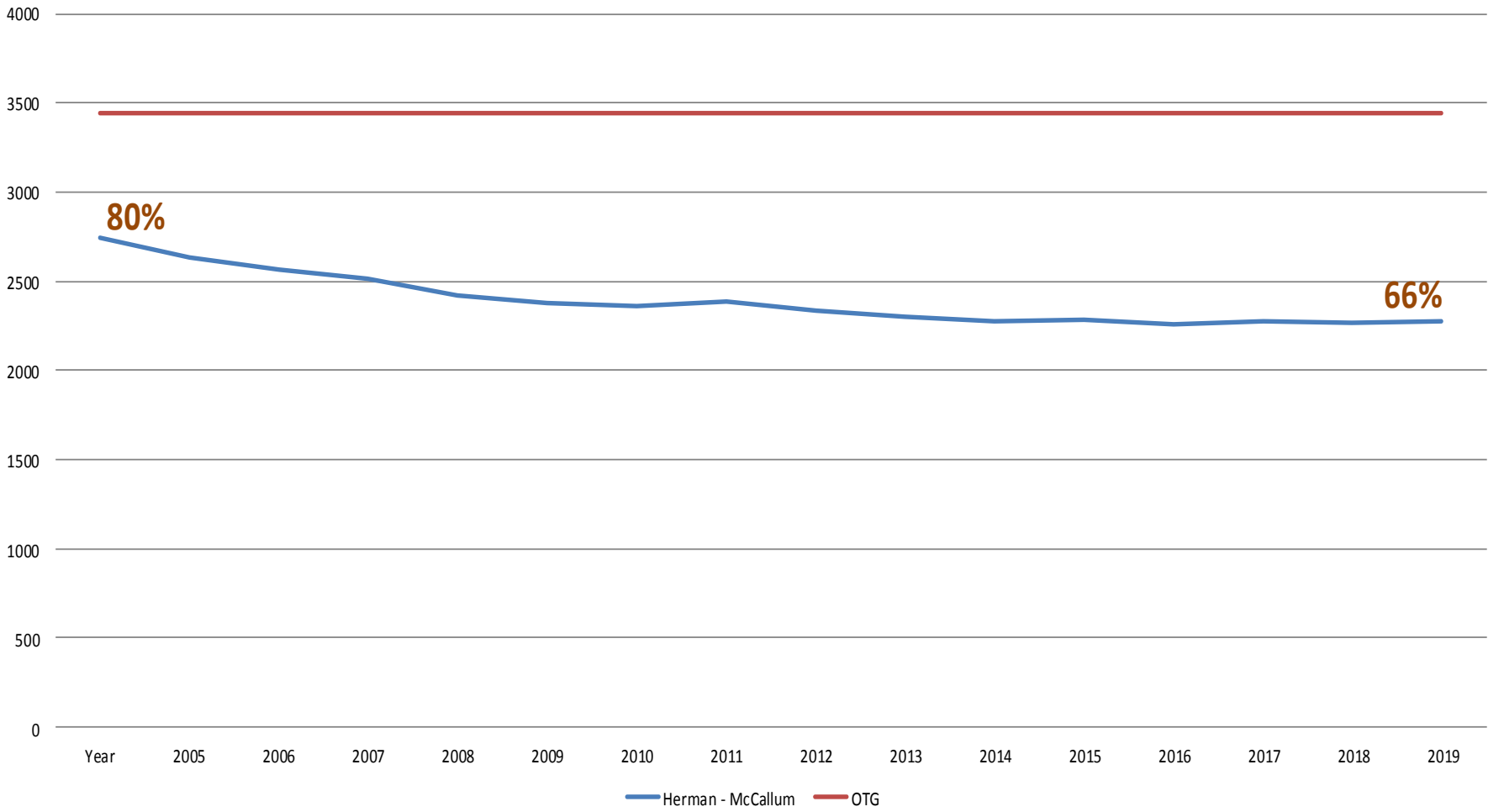

McCallum Public School

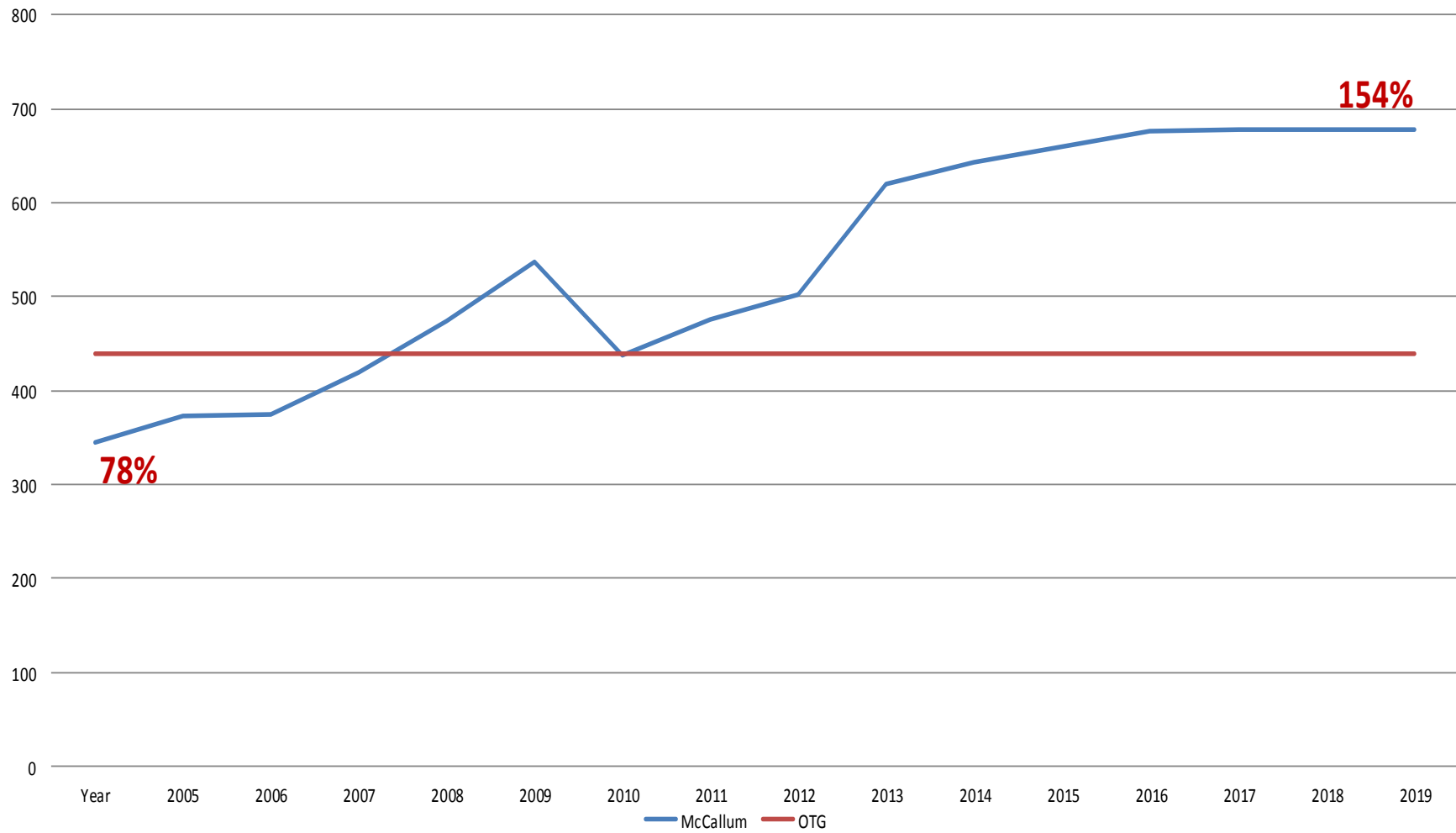

School	Renewal Needs 2010/2011	Utilization Rate
Coronation (average age = 1963)	\$ 1,830,238	62%
Davis (age = 1968)	\$ 1,557,741	77%
Maxwell (average age = 1954)	\$ 4,896,111	102%
McGregor (age = 1925)	\$ 7,608,072	58%
Roseville (age = 1972)	\$ 1,457,143	71%
McCallum (age = 1966)	\$ 2,876,659	107%
Herman (age = 1969)	\$ 11,261,597	61%

FCI vs. % Utilization by Family of Schools

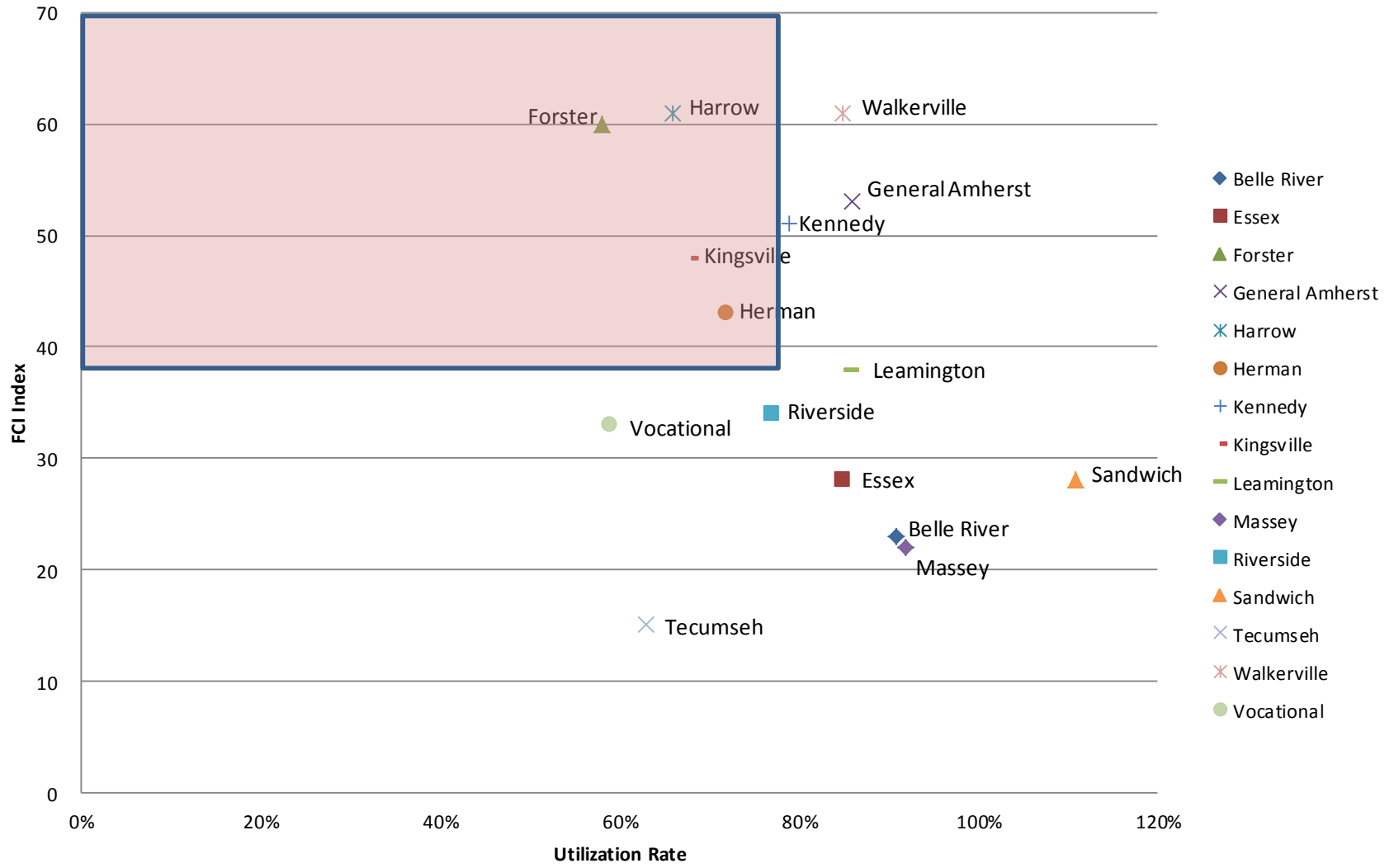

THE PARC PROCESS

- Committee is formed with representation from every school participating in the PARC
- PARC Committee has regular meetings to review data and determine recommendations
- Four Public Consultation meetings
- Committee writes a report and submits recommendations to the Director
- Director analyses committee report and submits recommendations to the Trustees
- Trustees vote and make the final decision

COMMITTEE COMPOSITION

Each school will be represented by:

- 2 parents/guardians
- School Principal
- 1 Teaching Staff
- 1 Superintendent
- 1 Recording Secretary
- The Committee as a whole will have 3 participants from the broader general public

WHY HERMAN FAMILY?

- Herman Family of Schools continues to have some of the oldest infrastructures in the Board
- Herman Family of Schools has one of the lowest utilization rates in the Board
- Enrolment projections continue to remain low for the next twenty years
- The current situation is not sustainable

Herman Family of Schools Student Spaces

Year	Coronation	Maxwell	McCallum	Roseville	Davis	McGregor	Herman	Total
Capacity	334	305	440	372	420	636	1374	3 881
Sept. 2011	206	312	472	265	321.5	369.5	839	2 785
Empty Seats	128	0	0	107	98.5	266.5	535	1 135
% Capacity	62%	102%	107%	71%	77%	58%	61%	72%

Enrolment Projections

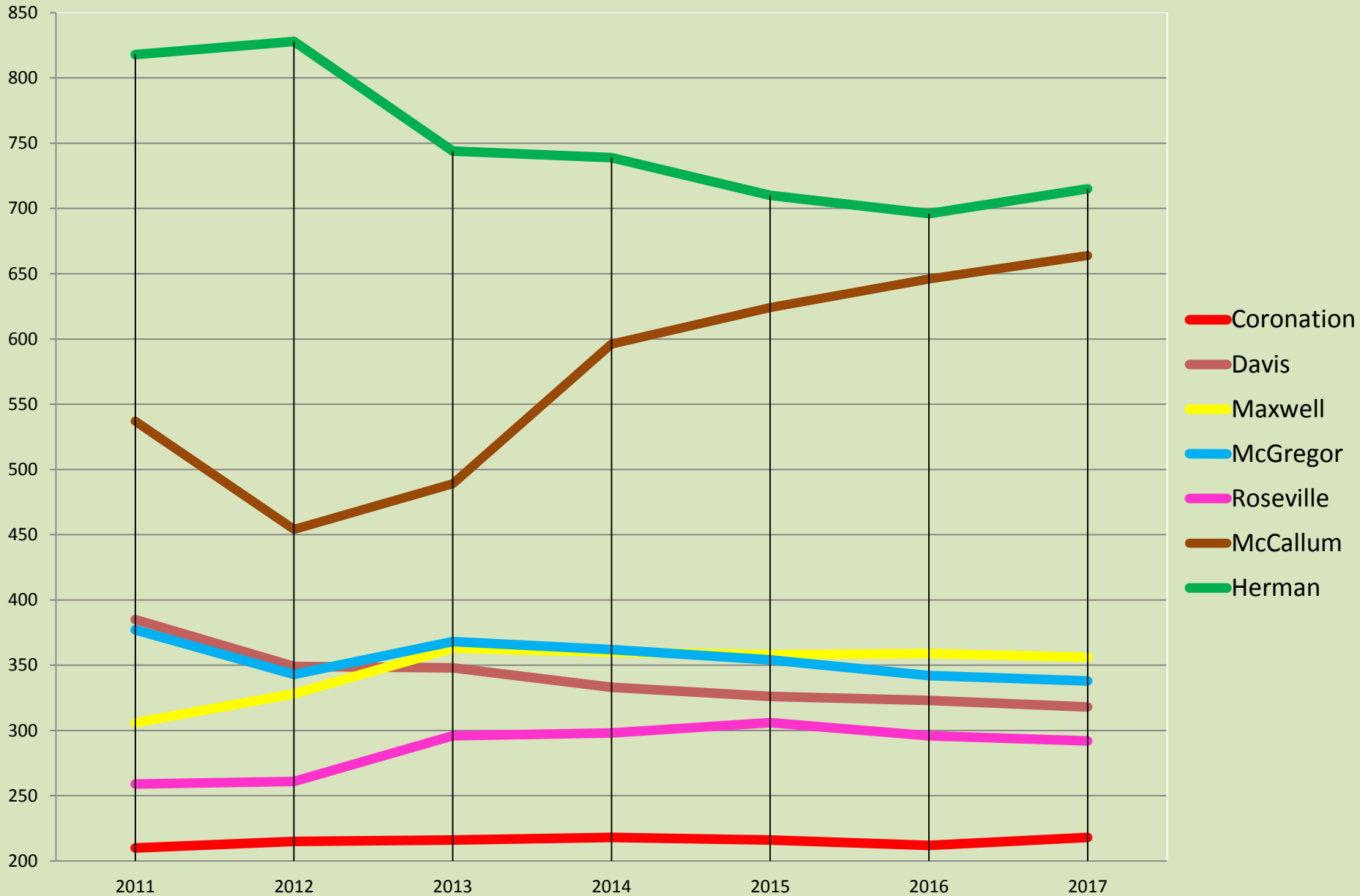

School Facility Data

Item	Coronation	Maxwell	McCallum	Roseville	Davis	McGregor	Herman
Usage Rate	62%	102%	107%	71%	77%	58%	61%
FCI	32.78%	96.04%	39.11%	23.43%	22.19%	71.57%	36.12%
FCI in 10 years	45.99%	146.06%	60.22%	37.91%	35.18%	111.64%	71.39%
Renewal Backlog	\$1.8 M	\$4.9 M	\$2.9 M	\$1.5 M	\$1.5 M	\$7.6 M	\$11.26 M
Renewal Backlog (10 years)	\$2.57 M	\$7.45 M	\$4.43 M	\$2.36 M	\$2.47 M	\$11.87 M	\$22.26 M

Guiding Principles

- In the course of discussion, the committee came to consensus on basic issues that we came to consider our guiding principles. We worked together to make the greatest impact with the least amount of disruption possible.

#1

- Herman High School *must* remain open:
 - Lack of availability at neighbouring secondary schools
 - Many grants and programs are housed here, such as French Immersion, Technology Department, Urban programming etc.

#2

- It is necessary to close or consolidate schools.

#3

- There are two different challenges:
 - a) Over-enrolment at the French Immersion School (McCallum)
 - b) Under-enrolment in the remaining Herman feeder schools

#4

- Splitting students (dividing current school populations) from closed or consolidated schools needs to be minimized.

Option Number 1
Close Maxwell and Coronation

- Adjust McCallum's western boundary to Walker Road. All current McCallum students living west of Walker Road would attend Giles French Immersion (FI).
- All Grade 7 and 8 English students go to Herman.
- Maxwell closes. JK-6 Maxwell students transition to McGregor
- Coronation closes. JK-6 Coronation students transition to Roseville.

Option Number 2

Close McGregor /McCallum to Herman/Maxwell Boundaries Change

- McCallum students transition to Herman (JK-12)
- McGregor closes. McGregor students transition to the new McCallum
- Maxwell's eastern boundary adjusted to Pillette. Current Maxwell students living east of Pillette (not including Pillette Road) transition to Coronation.

Option Number 3

Close McGregor and Maxwell

- McCallum student transition to Herman (JK-12)
- McGregor closes. Students living north of Tecumseh Road transition to new McCallum. Students living south of Tecumseh Road would transition to Davis.
- Maxwell closes. Students living east of Pillette transition to Coronation. All other students transition to the new McCallum

Option Number 4

McGregor and Maxwell close/McCallum Boundary Change

- Maxwell Students east of Pillette move to Coronation
- Herman absorbs the remainder of the JK-8 English Students from McGregor and Maxwell
- McCallum remains French Immersion with new western Walker Road Boundary
- McGregor and Maxwell close

Recommendation:

- The PARC Committee has reviewed the final four options and have decided that Option #2 best meets our Guiding Principles as well as the mandate from the Trustees.
 - The committee feels it a very important part of our community to keep the high school open. Herman has 564 open spaces that need to be filled. Based on enrolment projections, the number of open spaces at Herman will continue to increase and the students have to come from somewhere.

How will this effect your child?

- The McGregor building will be closed and the entire student body will be re-located to the McCallum building
- The entire McCallum student body will be relocated to Herman Secondary school
- Students attending Maxwell that live east of Pillette (not including Pilette Road) transition to Coronation.

Rationale behind this choice:

Using 2015 data:

	Utilization rate
Roseville stays the same: (278/ 372 OTG)	75%
Davis stays the same: (359/420 OTG)	86%
Herman: Add 643 students from McCallum (698+643= 1341/1374 OTG)	98%
Coronation: Add 95 students from Maxwell (211 + 80= 306/ 334 OTG)	92%
Maxwell: Remove 95 students to go to Coronation (330-95= 235/305 OTG)	77%
New McCallum (formerly McGregor): (388/ 440 OTG)	88%

Add numbers:

278 (Roseville)+359 (Davis)+ 1341 (Herman)+ 306 (Coronation) + 235 (Maxwell) + 388 (New McCallum))= 2907 students
372 (R) + 420(D) +1374 (H) +334 (C) +305 (M) +440 (NM) = 3245 spaces (OTG)

2907/ 3245= 89.5% overall utilization rate

Advantages:

- Close the school with the highest dollar amount for repairs (\$7,608,072)
- Support the mandate of keeping Herman open by filling it
- Alleviate overcrowding issue at McCallum
- Support the mandate to affect the least number of students possible by preventing most students from being separated from their classmates. Only 95 students from Maxwell are divided from their classmates; the rest stay together
- Fill spots at Coronation

What will this look like?

- 381 McGregor students move to McCallum
- 438 McCallum students move to Herman
- 95 Maxwell students move to Coronation
(boundary change)

1st Floor

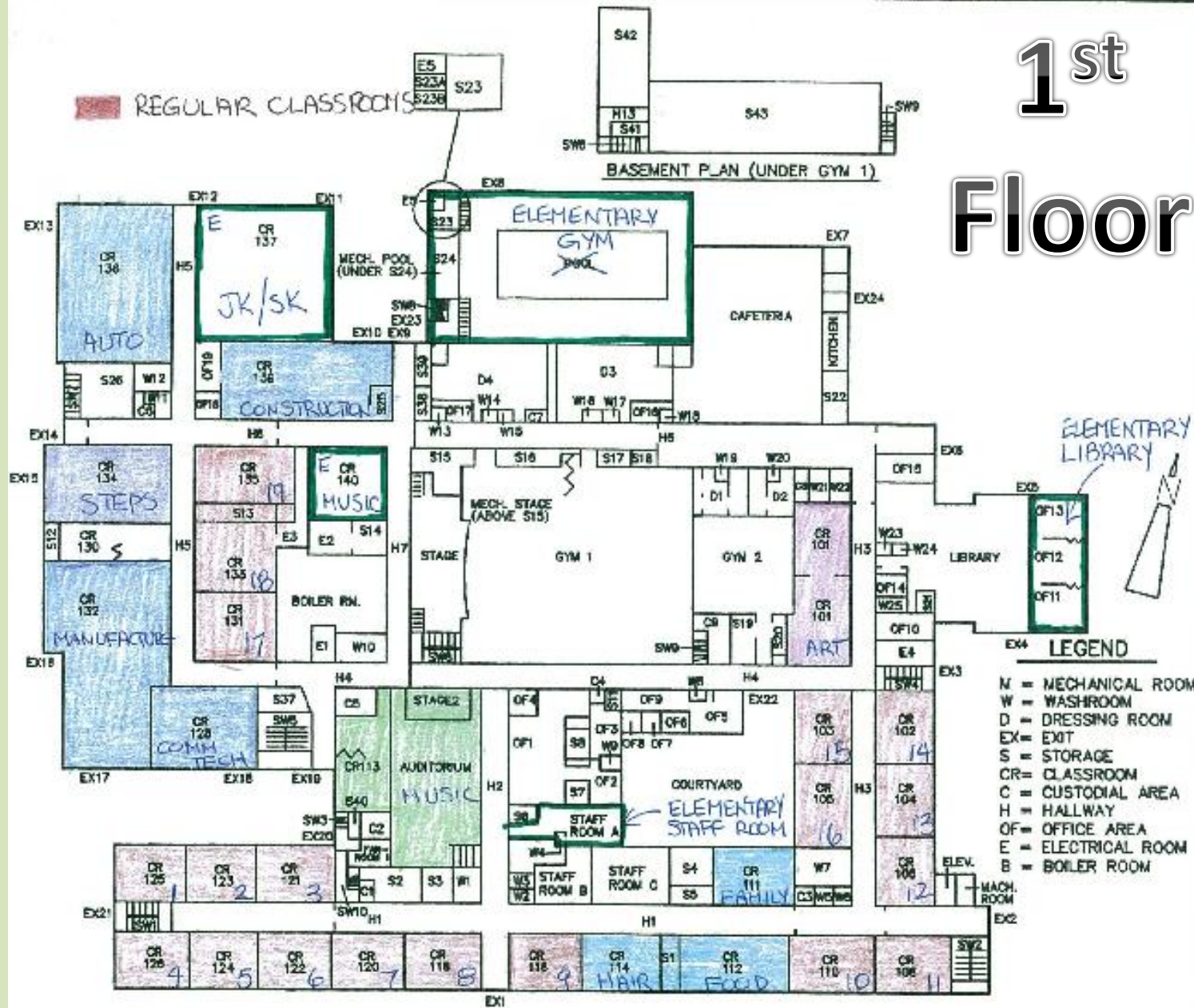

GREATER ESSEX COUNTY
DISTRICT SCHOOL BOARD
HERMAN SECONDARY

TITLE:
FIRST FLOOR

DRAWN BY:
B.D.

SCALE:
N.T.S.

DATE:
NOVEMBER 2011

ADDRESS:
1930 ROSSIGN
WINDSOR, ONT.
N6W 4P5

LEGEND

- M = MECHANICAL ROOM
- W = WASHROOM
- EX= EXIT
- S = STORAGE
- CR= CLASSROOM
- C = CUSTODIAL AREA
- H = HALLWAY
- OF= OFFICE AREA
- E = ELECTRICAL ROOM

2nd Floor

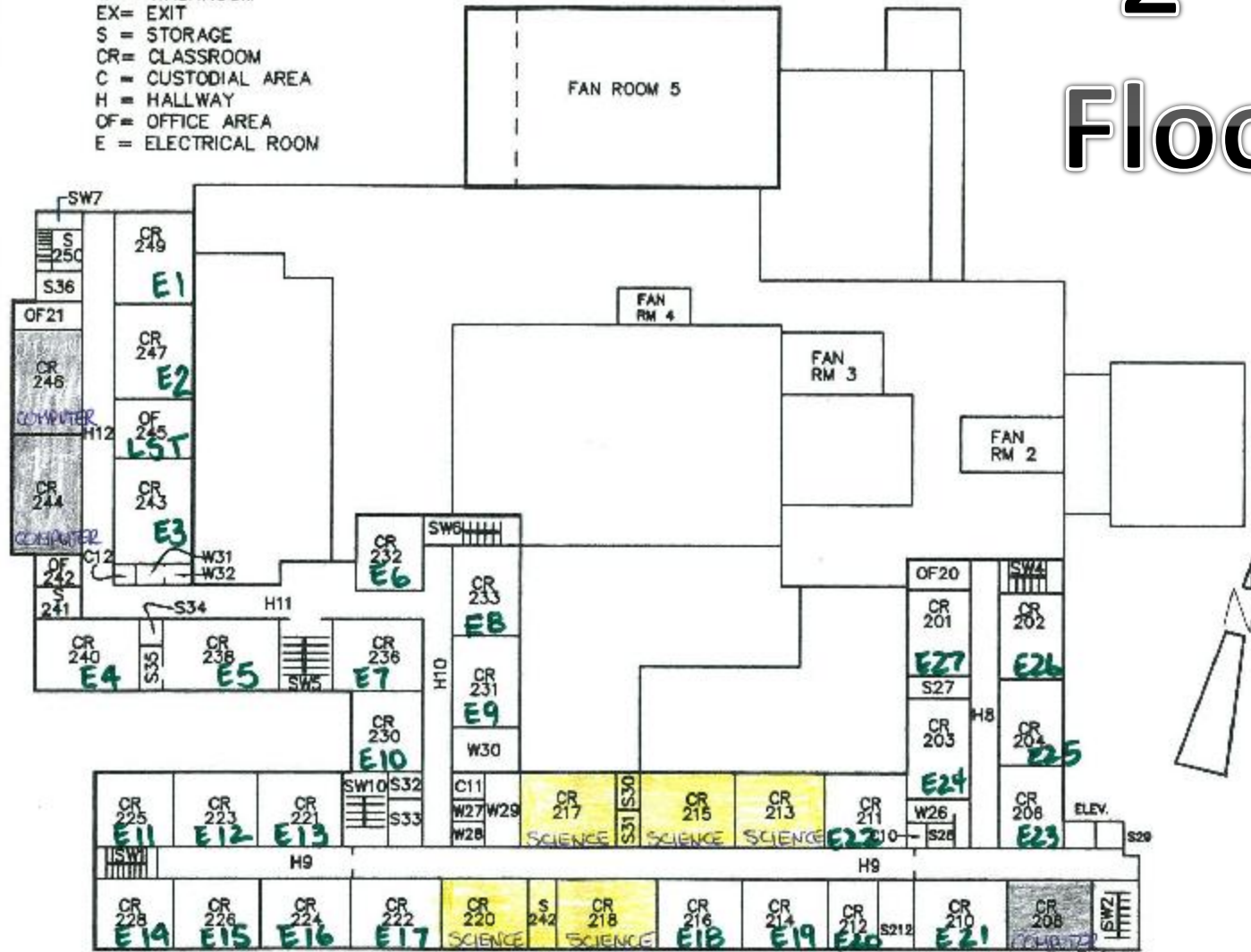

GREATER ESSEX COUNTY DISTRICT SCHOOL BOARD
 HERMAN SECONDARY

TITLE:

SECOND FLOOR

DRAWN BY:

B.D.

SCALE:

H.T.S.

DATE:

MARCH 2004

ADDRESS:

1930 ROSSINI WINDSOR, ONT. N9W 4P5

Transportation Policy

Statement

Upon written request from a parent or guardian, WESTS can offer transportation services to students attending schools in their designated school zone areas based on the eligibility policies as set out by the member boards.

Policy

Students may access transportation services if they are attending a Board designated school and their primary address is at a distance of more than:

- 1.0km, for junior and senior kindergarten;
 - 1.6kms, for Grade 1 to Grade 8 inclusively;
 - 3.2kms, for Grade 9 to Grade 12 inclusively and students in Grade 7 and Grade 8 attending a secondary school.
-
- **Student's primary address**
 - A student's address is his/her legal and permanent place of residence. This address determines his/her Board designated school. In the case of joint custody, it is the parents' responsibility to decide on the primary address, in order to determine his/her school catchment area.
 - Please note that the address of a daycare centre cannot be considered a student's legal and permanent address.

Presentation to Trustees

- The final report will be presented at a Special Board meeting of June 20, 2012
 - The public is welcome to attend this meeting.